

ORDINANCE NO. 17-1835

AN ORDINANCE OF
THE VILLAGE OF SHOREWOOD, WILL COUNTY ILLINOIS
DESIGNATING THE JEFFERSON STREET/RT 59 REDEVELOPMENT PROJECT
AREA
OF SAID VILLAGE A REDEVELOPMENT PROJECT AREA PURSUANT TO THE
TAX INCREMENT ALLOCATION REDEVELOPMENT ACT, AS AMENDED
("JEFFERSON STREET/RT 59 TIF")

WHEREAS, it is desirable and for the best interests of the citizens of the Village of Shorewood, Will County, Illinois (the "Village"), for the Village to implement tax increment allocation financing pursuant to the Tax Increment Allocation Redevelopment Act (65 ILCS 5/11-74.4-1 *et seq.*) as amended (the "Act"), for a proposed redevelopment plan and redevelopment project (the "Plan" and "Project") within the boundaries of the Village and within a proposed redevelopment project area (the "Area") described in Section 1 of this ordinance; and

WHEREAS, the Corporate Authorities have heretofore by ordinance adopted and approved the Plan and Project, which Plan and Project were identified in such ordinance and were the subject, along with the Area designation hereinafter made, of a public hearing held on January 24, 2017, and it is now necessary and desirable to designate the Area as a Redevelopment Project Area pursuant to the Act; and

WHEREAS, the Village has provided all notices, convened a public meeting, convened a joint review board and has otherwise complied with all requirements of the Act.

NOW, THEREFORE, BE IT ORDAINED by the President and Board of Trustees of the Village of Shorewood, Will County, Illinois, in the exercise of its statutory, home rule and other powers, as follows:

Section 1: Area Designated

The Area, as described in Exhibit "A" attached hereto and incorporated herein as if set

out in full by this reference, is hereby designated as a Redevelopment Project Area pursuant to Section 11-74.4-4 of the Act. The street location (as near as practicable) for the Area is described in Exhibit “B” attached hereto and incorporated herein as if set out in full by this reference. The map of the Area is depicted on Exhibit “C” attached hereto and incorporated herein as if set out in full by this reference.

Section 2: Invalidity of Any Section

If any section, paragraph or provision of this ordinance shall be held to be invalid or unenforceable for any reason, the invalidity or unenforceability of such section, paragraph or provision shall not affect any of the remaining provisions of this ordinance.

Section 3: Supceded and Effective Date

All ordinances, resolutions, motions or orders in conflict herewith be, and the same hereby are, repealed to the extent of such conflict, and this ordinance shall be in full force and effect upon its passage by the Corporate Authorities and its approval and publication as provided by law. This Ordinance shall be published in pamphlet form.

Section 4: Severability

This Ordinance, and every provision thereof, shall be considered severable. In the event that any court of competent jurisdiction may find and declare any word, phrase, clause, sentence, paragraph, provision or section or part of a phrase, clause, sentence, paragraph, provision or section of this Ordinance is void or unconstitutional, the remaining words, phrases, clauses, sentences, paragraphs and provisions and parts of phrases, clauses, sentences, paragraphs, provisions and sections not ruled void or unconstitutional shall continue in full force and effect.

PASSED this 14th day of February, 2017 with 5 members voting aye, 0 members voting nay, the President - voting, with 1 members abstaining or passing and said vote being:

DANIEL J. ANDERSON Abstain

ANTHONY M. LUCIANO Aye

STEVAN A. BROCKMAN Aye

EDMUND W. MURPHY Aye

BARBARA J. KIRKLAND Aye

DANIEL R. WARREN Aye

Tracy Ragusa
VILLAGE CLERK

APPROVED this 14th day of February, 2017.

GE Chapman
VILLAGE PRESIDENT

ATTEST:
Tracy Ragusa
VILLAGE CLERK



**SHOREWOOD TIF DISTRICT
JEFFERSON (ROUTE 52) & ROUTE 59 TIF DISTRICT**

THAT PART OF THE SOUTHEAST QUARTER OF SECTION 9, THE SOUTH HALF OF SECTION 10, THE WEST HALF OF SECTION 15 AND THE EAST HALF OF SECTION 16, TOWNSHIP 35 NORTH, RANGE 9 EAST OF THE THIRD PRINCIPAL MERIDIAN IN WILL COUNTY, ILLINOIS, BEING DESCRIBED AS FOLLOWS:

BEGINNING AT THE POINT OF INTERSECTION OF THE WEST LINE OF THE SOUTHEAST QUARTER OF SAID SECTION 9 AND THE NORTH RIGHT-OF-WAY LINE OF ROUTE 52 (AKA JEFFERSON STREET); THENCE EAST ALONG SAID NORTH RIGHT-OF-WAY LINE OF ROUTE 52 TO THE SOUTHWEST CORNER OF BUSINESS LOT 2 IN BROOK FOREST ANNEX, AS RECORDED NOVEMBER 15, 1961 AS DOCUMENT NUMBER 943655; THENCE NORTH ALONG THE WEST LINE OF SAID BUSINESS LOT 2 AND THE NORTHERLY EXTENSION THEREOF TO THE NORTHWEST CORNER OF BUSINESS LOT 4 IN SHOREWOOD PLAZA UNIT NO. 1, AS RECORDED DECEMBER 31, 1982 AS DOCUMENT NO. R82-016994; THENCE EAST ALONG THE NORTH LINE OF SAID BUSINESS LOT 4 TO THE NORTHEAST CORNER THEREOF, SAID NORTHEAST CORNER ALSO BEING A POINT ON THE EAST LINE OF THE WEST HALF OF SAID SOUTHEAST QUARTER OF SECTION 9; THENCE NORTH ALONG SAID EAST LINE TO THE NORTHWEST CORNER OF LOT 7 IN BROOK FOREST PLAZA, AS RECORDED JANUARY 29, 2001 AS DOCUMENT NUMBER R2001-010333; THENCE EASTERLY ALONG THE NORTH LINE OF SAID LOT 7 AND IT'S EASTERLY EXTENSION TO A POINT ON THE EAST RIGHT-OF-WAY LINE OF ILLINOIS ROUTE 59, PER DEDICATION RECORDED IN BOOK NUMBER 742, PAGE 643, AS DOCUMENT NUMBER 463798; THENCE SOUTH ALONG SAID EAST RIGHT-OF-WAY LINE OF ILLINOIS ROUTE 59 TO A POINT THAT IS 165 FEET NORTH OF THE NORTH RIGHT-OF-WAY LINE OF ROUTE 52 (AKA JEFFERSON STREET), PER PLAT OF HIGHWAY RECORDED AS DOCUMENT NUMBER R91-13980; THENCE EASTERLY AT RIGHT ANGLES TO THE LAST DESCRIBED COURSE 57.00 FEET; THENCE SOUTHERLY AT RIGHT ANGLES TO THE LAST DESCRIBED COURSE 15.00 FEET; THENCE EASTERLY AT RIGHT ANGLES TO THE LAST DESCRIBED COURSE 282.00 FEET; THENCE SOUTHERLY AT RIGHT ANGLES TO THE LAST DESCRIBED COURSE 155.14 FEET TO A POINT ON SAID NORTH RIGHT-OF-WAY LINE OF ROUTE 52 (AKA JEFFERSON STREET); THENCE EAST ALONG SAID NORTH RIGHT-OF-WAY LINE OF ROUTE 52 (AKA JEFFERSON STREET) TO A POINT ON A LINE PARALLEL TO THE EAST LINE OF THE EAST HALF OF THE SOUTHWEST QUARTER OF SAID SECTION 10, SAID PARALLEL LINE COMMENCING 280.5 FEET EAST OF THE SOUTHWEST CORNER OF SAID EAST HALF OF THE SOUTHWEST QUARTER; THENCE NORTH ALONG SAID PARALLEL LINE 165.00 FEET; THENCE EAST PARALLEL TO THE SOUTH LINE OF SAID SOUTHWEST QUARTER 132.00 FEET; THENCE NORTHEASTERLY ALONG THE EASTERLY LINE OF THE PREMISES CONVEYED TO THE FOREST PRESERVE DISTRICT OF WILL COUNTY, ILLINOIS, BY DEED RECORDED NOVEMBER 25, 1930, IN BOOK 740, PAGE 100, AS DOCUMENT NUMBER 446087, 380.9 FEET TO A POINT ON LINE, SAID LINE LYING 453.34 FEET NORTH OF AND PARALLEL TO THE SOUTH LINE OF SAID SOUTHWEST QUARTER; THENCE EAST ALONG SAID PARALLEL LINE TO A POINT ON THE WESTERLY RIGHT-OF-WAY LINE OF INTERSTATE 55, AS RECORDED MARCH 29, 1956 AS DOCUMENT NUMBERS 795602 AND 795608, SAID WESTERLY RIGHT-OF-WAY LINE OF INTERSTATE 55 ALSO BEING THE WESTERLY LINE OF THE NORTH-SOUTH FRONTAGE ROAD; THENCE NORTHEASTERLY THEN NORTHERLY ALONG SAID WESTERLY LINE TO A POINT OF INTERSECTION WITH THE WESTERLY EXTENSION OF THE NORTH LINE OF THE SOUTH 350 FEET OF THE NORTH 1035 FEET OF THE WEST HALF OF THE SOUTHEAST QUARTER OF SAID SECTION 10; THENCE EAST ALONG SAID EXTENSION AND NORTH LINE OF THE SOUTH 350 FEET OF THE NORTH 1035 FEET TO A POINT ON THE WESTERLY RIGHT-OF-

WAY LINE OF INTERSTATE 55, AS RECORDED MARCH 29, 1956 AS DOCUMENT NUMBER 795600; THENCE NORTHEASTERLY ALONG SAID WESTERLY RIGHT-OF-WAY LINE TO A POINT OF INTERSECTION WITH THE NORTHWESTERLY EXTENSION OF THE NORTHEASTERLY RIGHT-OF-WAY LINE OF DEER RUN TRAIL; THENCE SOUTHEASTERLY ALONG SAID EXTENSION, THE NORTHEASTERLY RIGHT-OF-WAY LINE OF DEER RUN TRAIL AND SOUTH ALONG THE EAST RIGHT-OF-WAY LINE OF DEER RUN TRAIL TO IT'S SOUTH MOST TERMINUS; THENCE WEST ALONG THE SOUTH TERMINUS OF DEER RUN TRAIL TO A POINT ON THE EAST LINE OF THE WEST HALF OF THE SOUTHEAST QUARTER OF SAID SECTION 10; THENCE SOUTH ALONG SAID EAST LINE OF THE WEST HALF OF THE SOUTHEAST QUARTER TO THE SOUTHEAST CORNER OF SAID WEST HALF OF THE SOUTHEAST QUARTER; THENCE WEST ALONG THE SOUTH LINE OF THE SOUTH HALF OF SAID SECTION 10 TO A POINT ON THE WESTERLY RIGHT-OF-WAY LINE OF INTERSTATE 55, AS RECORDED MARCH 29, 1956 AS DOCUMENT NUMBER 795605; THENCE SOUTHWESTERLY ALONG SAID WESTERLY RIGHT-OF-WAY LINE OF INTERSTATE 55 TO A POINT ON THE SOUTH RIGHT-OF-WAY LINE OF AFORESAID ROUTE 52 (AKA JEFFERSON STREET); THENCE WEST ALONG SAID SOUTH RIGHT-OF-WAY LINE OF ROUTE 52 (AKA JEFFERSON STREET) TO A POINT ON THE EAST RIGHT-OF-WAY LINE OF MARY STREET; THENCE SOUTH ALONG SAID EAST RIGHT-OF-WAY LINE OF MARY STREET TO A POINT ON THE NORTH RIGHT-OF-WAY LINE OF WILLIAM STREET; THENCE WEST ALONG SAID NORTH RIGHT-OF-WAY LINE OF WILLIAM STREET TO A POINT ON THE CENTERLINE OF SAID MARY STREET; THENCE SOUTH AT RIGHT ANGLES TO A POINT ON THE CENTERLINE OF SAID WILLIAM STREET; THENCE WEST ALONG SAID CENTERLINE OF WILLIAM STREET TO A POINT ON THE WEST LINE OF THE EAST HALF OF THE NORTHWEST QUARTER OF SECTION 15; THENCE SOUTH ALONG SAID WEST LINE TO THE SOUTHEAST CORNER OF DANTE STOBBEONES SUBDIVISION UNIT NO.1 AS RECORDED NOVEMBER 8, 1952 AS DOCUMENT NUMBER 717748; THENCE WEST ALONG THE SOUTH LINE OF SAID DANTE STOBBEONES SUBDIVISION UNIT NO. 1 TO THE SOUTHEAST CORNER OF DANTE STOBBEONES SUBDIVISION UNIT NO. 2 AS RECORDED JUNE 20, 1953 AS DOCUMENT NUMBER 730401; THENCE WEST ALONG THE SOUTH LINE OF SAID DANTE STOBBEONES SUBDIVISION UNIT NO. 2 TO THE SOUTHEAST CORNER OF DANTE STOBBEONES SUBDIVISION UNIT NO. 3 AS RECORDED MAY 5, 1959 AS DOCUMENT NUMBER 875427; THENCE WEST ALONG THE SOUTH LINE OF SAID DANTE STOBBEONES SUBDIVISION UNIT NO. 3 TO THE EAST LINE OF THE WEST 267.89 FEET OF THE SOUTH 52 ACRES OF THE WEST HALF OF THE NORTHWEST QUARTER OF SAID SECTION 15; THENCE SOUTH ALONG SAID EAST LINE TO A POINT ON THE NORTH LINE OF THE SOUTH 134.75 FEET OF THE NORTH 269.5 FEET OF SAID SOUTH 52 ACRES; THENCE EAST ALONG SAID NORTH LINE TO A POINT ON THE EAST LINE OF THE WEST 317.89 FEET OF SAID SOUTH 52 ACRES; THENCE SOUTH ALONG SAID EAST LINE TO A POINT ON THE SOUTH LINE OF THE NORTH 269.5 FEET OF SAID SOUTH 52 ACRES; THENCE WEST ALONG SAID SOUTH LINE TO A POINT ON THE EAST RIGHT-OF-WAY LINE OF AFORESAID ILLINOIS ROUTE 59; THENCE SOUTH ALONG SAID EAST RIGHT-OF-WAY LINE TO A POINT ON THE NORTH RIGHT-OF-WAY LINE OF SCHOOL ROAD; THENCE EAST ALONG SAID NORTH RIGHT-OF-WAY LINE TO A POINT OF INTERSECTION WITH THE NORTHERLY EXTENSION OF THE EAST RIGHT-OF-WAY LINE OF HELENE AVENUE; THENCE SOUTH ALONG SAID EXTENSION AND EAST RIGHT-OF-WAY LINE OF HELENE AVENUE TO A POINT ON THE SOUTH RIGHT-OF-WAY LINE OF SARAH AVENUE; THENCE WEST ALONG SAID SOUTH RIGHT-OF-WAY LINE OF SARAH AVENUE TO THE NORTHWEST CORNER OF SUNSET HILLS SUBDIVISION UNIT NO. 3 AS RECORDED APRIL 10, 1963 AS DOCUMENT NUMBER 981203; THENCE SOUTH ALONG THE WEST LINE OF SAID SUNSET HILLS SUBDIVISION UNIT NO. 3 TO THE SOUTHWEST CORNER THEREOF, SAID SOUTHWEST CORNER ALSO BEING A POINT ON THE SOUTH LINE OF THE NORTHWEST QUARTER OF SAID SECTION 15; THENCE EAST ALONG SAID

SOUTH LINE TO A POINT ON THE WESTERLY RIGHT-OF-WAY LINE OF INTERSTATE 55; THENCE SOUTHWESTERLY ALONG SAID WESTERLY RIGHT-OF-WAY LINE OF INTERSTATE 55 TO A POINT OF MERGING WITH THE NORTHEASTERLY RIGHT-OF-WAY LINE OF AFORESAID ILLINOIS ROUTE 59; THENCE NORTHWESTERLY ALONG SAID NORTHEASTERLY RIGHT-OF-WAY LINE OF ILLINOIS ROUTE 59 TO A POINT OF INTERSECTION WITH THE EASTERLY EXTENSION OF THE SOUTH RIGHT-OF-WAY LINE OF AMENDODGE DRIVE; THENCE WEST ALONG SAID EASTERLY EXTENSION AND THE SOUTH RIGHT-OF-WAY LINE OF AMENDODGE DRIVE TO A POINT OF INTERSECTION WITH THE SOUTHERLY EXTENSION OF THE OF THE WEST LINE OF LOT 1 IN AMENDODGE INDUSTRIAL PARK, AS RECORDED JUNE 2, 1977 AS DOCUMENT NUMBER R77-18311; THENCE NORTH ALONG SAID SOUTHERLY EXTENSION AND WEST LINE OF LOT 1 TO THE NORTHWEST CORNER THEREOF, SAID NORTHWEST CORNER ALSO BEING A POINT ON THE SOUTH LINE OF THE NORTH 346 FEET OF THE SOUTHEAST QUARTER OF SAID SECTION 16; THENCE WEST ALONG SAID SOUTH LINE TO THE SOUTHEAST CORNER OF LOT 35 IN OAKWOOD MANOR SUBDIVISION UNIT ONE, AS RECORDED JUNE 13, 1962 AS DOCUMENT NUMBER 958747; THENCE NORTH ALONG THE EAST LINE OF SAID LOT 35 AND IT'S NORTHERLY EXTENSION TO A POINT ON THE NORTH RIGHT-OF-WAY LINE OF OAKWOOD DRIVE; THENCE EAST ALONG SAID NORTH RIGHT-OF-WAY LINE OF OAKWOOD DRIVE TO THE SOUTHEAST CORNER OF LOT 1 IN SAID OAKWOOD MANOR SUBDIVISION UNIT ONE; THENCE NORTH ALONG THE EAST LINE OF SAID LOT 1 TO THE NORTHEAST CORNER THEREOF, SAID NORTHEAST CORNER ALSO BEING A POINT ON THE NORTH LINE OF SAID SOUTHEAST QUARTER OF SECTION 16; THENCE EAST ALONG SAID NORTH LINE TO THE SOUTHEAST CORNER OF LOT 57 IN SHOREWOOD PARK SUBDIVISION UNIT FOUR, AS RECORDED JULY 17, 1961 AS DOCUMENT NUMBER 934092; THENCE NORTH ALONG THE EAST LINE OF SAID LOT 57 TO THE NORTHEAST CORNER THEREOF, SAID NORTHEAST CORNER ALSO BEING A POINT ON THE SOUTH RIGHT-OF-WAY LINE OF SHOREWOOD LANE; THENCE WEST ALONG SAID SOUTH RIGHT-OF-WAY LINE OF SHOREWOOD LANE TO A POINT OF INTERSECTION WITH THE SOUTHERLY EXTENSION OF THE OF THE WEST RIGHT-OF-WAY LINE OF FRANKLIN ROAD; THENCE NORTH ALONG SAID SOUTHERLY EXTENSION AND WEST RIGHT-OF-WAY LINE OF FRANKLIN ROAD TO A POINT ON THE SOUTH RIGHT-OF-WAY LINE OF MEYERS STREET; THENCE WEST ALONG SAID SOUTH RIGHT-OF-WAY LINE OF MEYERS STREET AND IT'S WESTERLY EXTENSION TO A POINT ON THE NORTHWESTERLY BANK OF THE DUPAGE RIVER; THENCE SOUTHWESTERLY ALONG SAID BANK TO A POINT ON THE SOUTHERLY EXTENSION OF THE WEST LINE OF SHOREWOOD BEACH SUBDIVISION, BEING A SUBDIVISION IN THE NORTHEAST QUARTER OF SAID SECTION 16, AS RECORDED JUNE 26, 1925 AS DOCUMENT NUMBER 381446; THENCE SOUTHERLY ALONG SAID SOUTHERLY EXTENSION TO A POINT ON THE CENTERLINE OF SAID DUPAGE RIVER; THENCE SOUTHWESTERLY ALONG SAID CENTERLINE OF THE DUPAGE RIVER TO THE MOST EASTERLY CORNER OF CORNER OF LOT 9 IN BROOKSHORE PARK SUBDIVISION UNIT 5, AS RECORDED DECEMBER 31, 1985 AS DOCUMENT NUMBER R85-027672; THENCE NORTHWESTERLY ALONG A LINE THAT INTERSECTS A POINT OF CURVATURE ON THE SOUTHEASTERLY RIGHT-OF-WAY LINE OF WESTSHORE DRIVE, SAID LINE ALSO BEING THE NORTHEASTERLY LINE OF THE PARCEL DESCRIBED IN THE DEED DOCUMENT R2003-048385, AS RECORDED MARCH 4, 2003; THENCE CONTINUING NORTHWESTERLY ALONG THE EXTENSION OF THE LAST DESCRIBED COURSE TO A POINT ON THE NORTHWESTERLY RIGHT-OF-WAY LINE OF SAID WESTSHORE DRIVE; THENCE NORTHEASTERLY ALONG SAID WESTSHORE DRIVE TO A POINT OF INTERSECTION WITH THE SOUTHWESTERLY RIGHT-OF-WAY LINE OF SUMMER STREET; THENCE NORTHWESTERLY AND NORTHERLY ALONG SAID SOUTHWESTERLY RIGHT-OF-WAY LINE OF SUMMER STREET TO THE SOUTHEAST CORNER OF LOT 99 IN SAID SHOREWOOD

BEACH SUBDIVISION; THENCE WEST ALONG THE SOUTH LINE OF SAID LOT 99 AND CONTINUING ALONG THE SOUTH LINE OF LOT 117 IN SAID SHOREWOOD BEACH SUBDIVISION AND IT'S WESTERLY EXTENSION TO A POINT ON THE WEST RIGHT-OF-WAY LINE OF PICNIC STREET; THENCE NORTH ALONG SAID WEST RIGHT-OF-WAY LINE OF PICNIC STREET TO THE SOUTHEAST CORNER OF LOT 150 IN SAID SHOREWOOD BEACH SUBDIVISION; THENCE WEST ALONG THE SOUTH LINE OF SAID LOT 150 TO THE SOUTHWEST CORNER THEREOF; THENCE NORTH ALONG THE WEST LINE OF SAID LOT 150 TO THE NORTHWEST CORNER THEREOF; THENCE EAST ALONG THE NORTH LINE OF SAID LOT 150 TO THE NORTHEAST CORNER THEREOF, SAID NORTHEAST CORNER ALSO BEING A POINT ON SAID WEST RIGHT-OF-WAY LINE OF PICNIC STREET; THENCE NORTH ALONG SAID WEST RIGHT-OF-WAY LINE OF PICNIC STREET TO A POINT ON THE NORTH LINE OF THE SOUTH HALF OF LOT 148 IN SAID SHOREWOOD BEACH SUBDIVISION; THENCE WEST ALONG SAID NORTH LINE OF THE SOUTH HALF OF LOT 148 TO A POINT ON THE WEST LINE OF SAID LOT 148; THENCE NORTH ALONG SAID WEST LINE OF LOT 148 TO THE NORTHWEST CORNER THEREOF, SAID NORTHWEST CORNER ALSO BEING THE SOUTHEAST CORNER OF LOT 172 IN SAID SHOREWOOD BEACH SUBDIVISION; THENCE WEST ALONG THE SOUTH LINE OF SAID LOT 172 AND IT'S WESTERLY EXTENSION TO A POINT ON THE WEST RIGHT-OF-WAY LINE OF TURTLE STREET; THENCE NORTH ALONG SAID WEST RIGHT-OF-WAY LINE OF TURTLE STREET TO THE SOUTHEAST CORNER OF LOT 205 IN SAID SHOREWOOD BEACH SUBDIVISION; THENCE WEST ALONG THE SOUTH LINE OF SAID LOT 205 TO THE SOUTHWEST CORNER THEREOF, SAID SOUTHWEST CORNER ALSO BEING A POINT ON THE WEST LINE OF THE EAST HALF OF THE NORTHEAST QUARTER OF SAID SECTION 16; THENCE NORTH ALONG SAID WEST LINE OF THE EAST HALF TO THE NORTHEAST CORNER OF TO THE NORTHEAST CORNER OF LOT 75 IN BROOKSHORE PARK UNIT THREE SUBDIVISION, AS RECORDED JULY 27, 1978 AS DOCUMENT NUMBER R78-29087; THENCE WEST TO THE SOUTHEAST CORNER OF LOT 1 IN BROOKSHORE PARK UNIT ONE SUBDIVISION, AS RECORDED AUGUST 4, 1977 AS DOCUMENT NUMBER R77-280085; THENCE WEST ALONG THE SOUTH LINE OF LOT 1 IN SAID BROOKSHORE PARK UNIT ONE SUBDIVISION AND CONTINUING ALONG THE SOUTH LINE OF LOTS 2 AND 3 TO A POINT ON THE EASTERLY RIGHT-OF-WAY LINE OF BROOKSHORE DRIVE; THENCE WESTERLY TO THE SOUTHEAST CORNER OF PARK PLACE PLAZA SUBDIVISION, AS RECORDED SEPTEMBER 25, 1990 AS DOCUMENT NUMBER R90-53104; THENCE SOUTHWESTERLY, NORTHWESTERLY, WESTERLY AND SOUTHERLY ALONG THE SOUTH LINE OF SAID PARK PLACE PLAZA SUBDIVISION TO A POINT ON THE NORTHERLY RIGHT-OF-WAY LINE OF RAVEN ROAD, SAID POINT ALSO BEING ON A CURVE CONCAVE TO THE SOUTH; THENCE SOUTHWESTERLY ALONG A LINE RADIAL TO SAID CURVE TO A POINT ON THE SOUTHERLY RIGHT-OF-WAY LINE OF SAID RAVEN ROAD; THENCE NORTHWESTERLY ALONG SAID SOUTHERLY RIGHT-OF-WAY LINE OF SAID RAVEN ROAD TO A POINT ON THE WEST LINE OF THE NORTHEAST QUARTER OF SAID SECTION 16; THENCE NORTH ALONG SAID WEST LINE OF THE NORTHEAST QUARTER OF SECTION 16 TO THE NORTHWEST CORNER THEREOF, SAID NORTHWEST CORNER ALSO BEING THE SOUTHWEST CORNER OF THE SOUTHEAST QUARTER OF AFORESAID SECTION 9; THENCE NORTH ALONG THE WEST LINE OF SAID SOUTHEAST QUARTER OF SECTION 9 TO THE POINT OF BEGINNING, ALL IN WILL COUNTY, ILLINOIS.

EXCLUDING THEREFROM THE FOLLOWING DESCRIBED PARCEL:

LOTS 56,57,58,67,68,88,89,90,91,92,93 AND THE NORTH HALF OF LOT 94 IN SHOREWOOD BEACH SUBDIVISION, BEING A SUBDIVISION IN THE NORTHEAST QUARTER OF SAID SECTION 16, AS RECORDED JUNE 26, 1925 AS DOCUMENT NUMBER 381446, ALL IN WILL COUNTY, ILLINOIS.

EXHIBIT B

The Redevelopment Area is generally bounded by frontage east and west along Interstate 55 to the northeast, Deerwood Drive and the Illinois Route 59/Jefferson Street shopping area to the northwest, Deer Run Trail to the east, Brookshore Drive and Summer Street to the west (including parcels on the north side and south side along the DuPage River, and Oakwood Drive, Channahon Street and Williams Street to the south. Adjacent right-of-ways are also included.

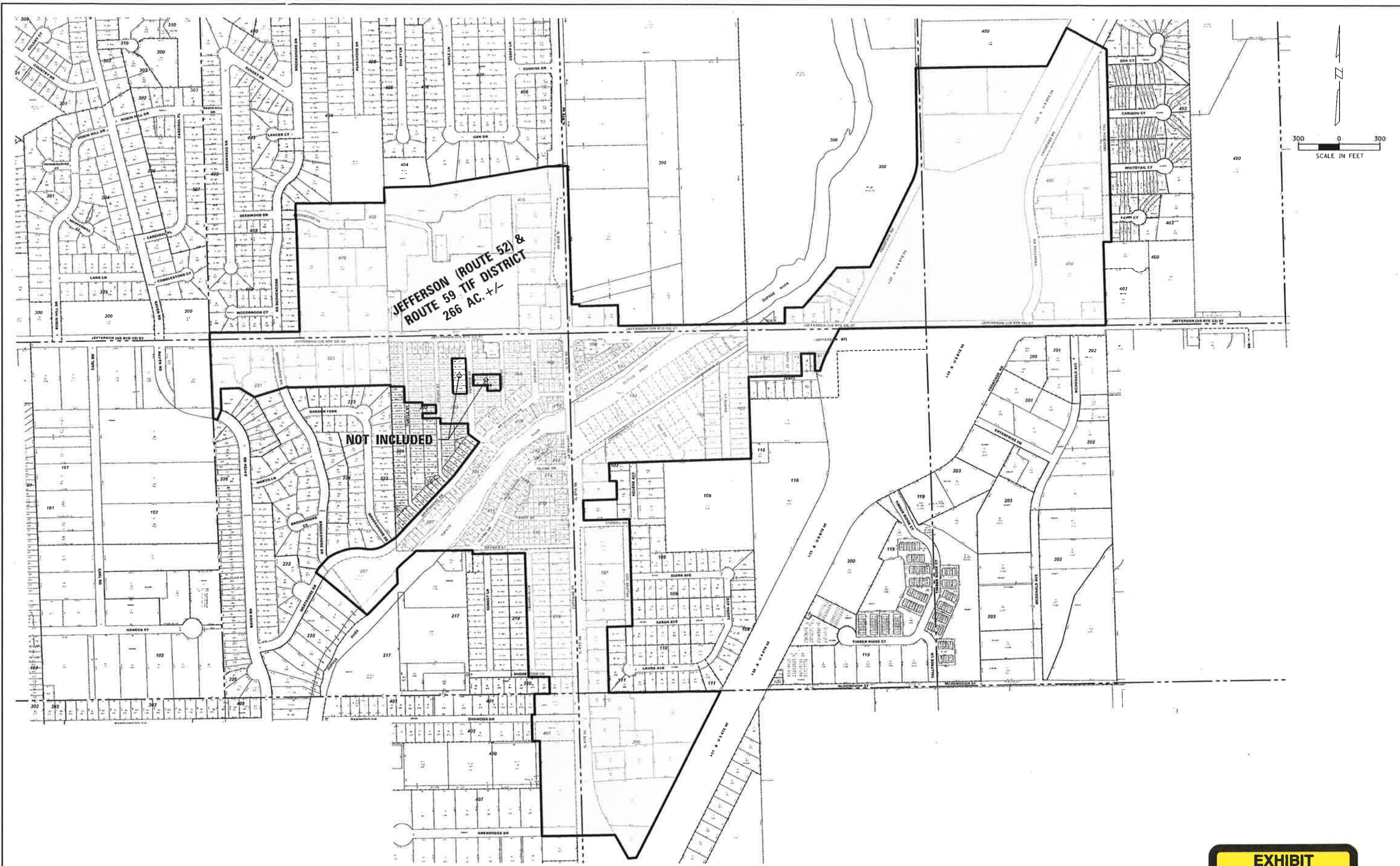

CB **CHRISTOPHER B. BURKE ENGINEERING, LTD.**
 9575 West Higgins Road, Suite 600
 Rosemont, Illinois 60018
 (847) 823-0500

JEFFERSON (ROUTE 52) & ROUTE 59 TIF DISTRICT
 IN
 VILLAGE OF SHOREWOOD, ILLINOIS
 PREPARED FOR
 KANE MCKENNA

CALC.	JRM	PROJECT NO.
DWN.	AJK	A1501
CHKD.	JRM	SHEET 1 OF 1
SCALE:	1" = 300'	DRAWING NO.
DATE:	10-01-2015	TIF070001A1501



N:\SHOREWOOD\070001\070001A\2015\AR01\SURVEY\TIF070001A1501.DWG